

**CLAYTON OFF ROAD  
COR-2204210  
JEEP GRAND CHEROKEE UNI-BODY FRAME RAILS (1993-1998, ZJ)**

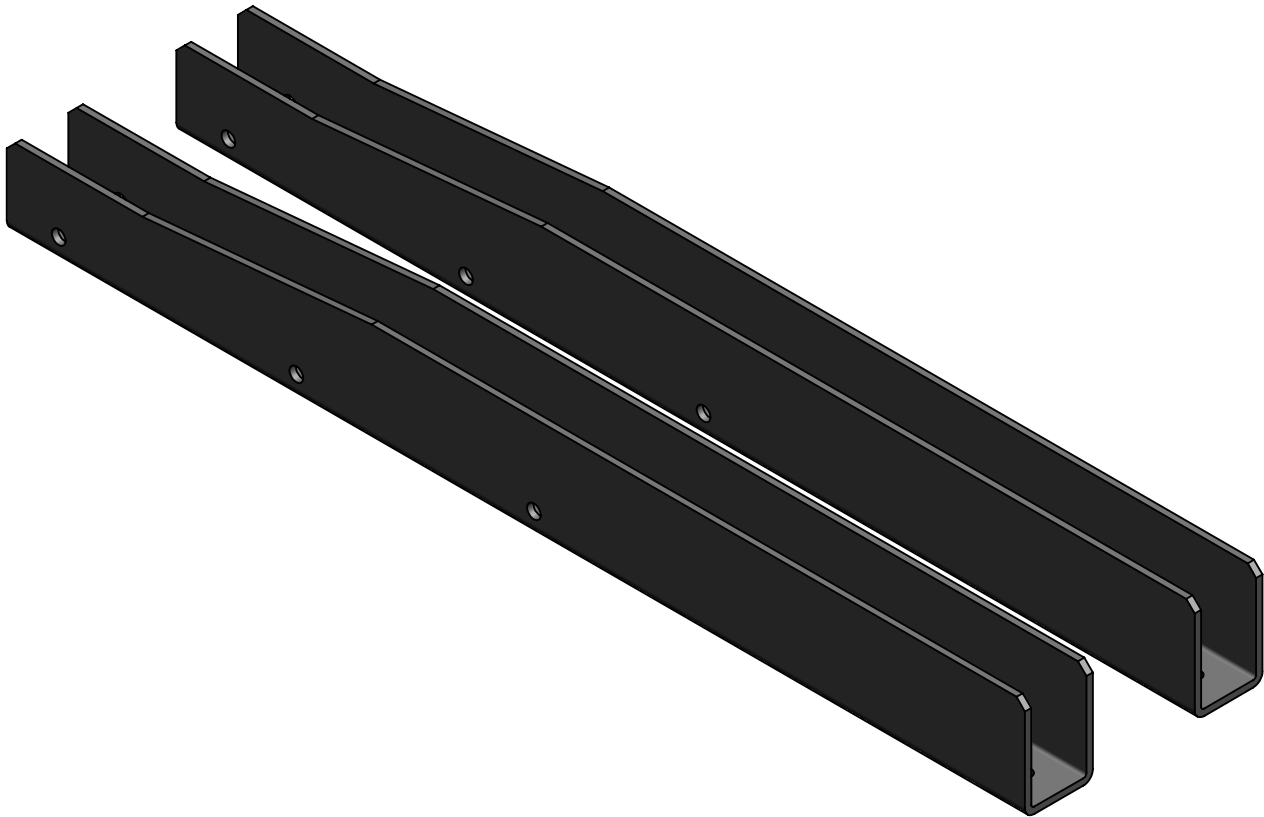

NOTES: This product requires general welding, fabrication and automotive mechanic skills. Welding should only be done by a competent welder. Clayton Off Road implies no guarantees or warranties and is not liable for improper installation. Some grinding and fitment may be required when installing this product. Every vehicle varies slightly and some fabrication may be required. For more information please visit our web site.

Refer to drawing views for measurements.

Step 1: Install part number COR-2104310 or COR-2104610 3 piece cross member.

Step 2: Install part number COR-2204110 rear frame brackets.

Step 1: Clean frame for welding.

Step 2: Locate rails according to dimensions given. Wood blocks and a bottle jack work well for holding the rails in place.

Step 3: Check fitment with ZJ 1/4" transfer case skid plate if using.

Step 4: Tack weld 4 corners of rails.

Step 5: Weld around 3 sides of the end of the rails.

Step 6: Weld along the insides and outside of the rails. Min. 6 welds spaced out.

Step 6: Paint sub frame rails.

Note: These frame rails can be installed alone but will interfere with installing other parts of our system in the future.

